

Client Info

Name: _____
 Email: _____
 Phone: _____

Reference

Designer: _____
 Contractor: _____
 Referred by: _____

Property Info

Address: _____

Description of Project

- | | |
|---------------------------------------|---------------------------------|
| <input type="radio"/> Rehab | <input type="radio"/> New Build |
| <input type="radio"/> Spot Relocation | <input type="radio"/> Addition |

Current Status of Project

- | | |
|----------------------------------|------------------------------------|
| <input type="radio"/> Needs Work | <input type="radio"/> Ripped Out |
| <input type="radio"/> Framed | <input type="radio"/> Sheet Rocked |

Style Info

Door Style: _____

Finish: _____

Desired Features

- | | |
|---|---|
| <input type="radio"/> Wine Storage | <input type="radio"/> Light Rail Molding |
| <input type="radio"/> Plate Rack | <input type="radio"/> Open Shelves |
| <input type="radio"/> Crown Molding | <input type="radio"/> Trash Pull Out Cabinet |
| <input type="radio"/> Crown to Ceiling | <input type="radio"/> Spice Pull Out Cabinet |
| <input type="radio"/> Roll Out Trays | <input type="radio"/> Lazy Susan |
| <input type="radio"/> Glass Doors | <input type="radio"/> Microwave Upper Cabinet |
| <input type="radio"/> Decorative Panels | <input type="radio"/> Microwave Base Cabinet |
| <input type="radio"/> Wood Hood | <input type="radio"/> Wide Storage Drawer(s) |
| <input type="radio"/> Base Molding | <input type="radio"/> Cutlery Dividers |
| <input type="radio"/> Farmhouse Sink | <input type="radio"/> Tip Out Trays |
| <input type="radio"/> ADA Compliant | <input type="radio"/> Other _____ |

NOTE: Features are not standard and add cost and value to your Project. Not all features are available in certain manufacturers or have the ability to fit into your Project.

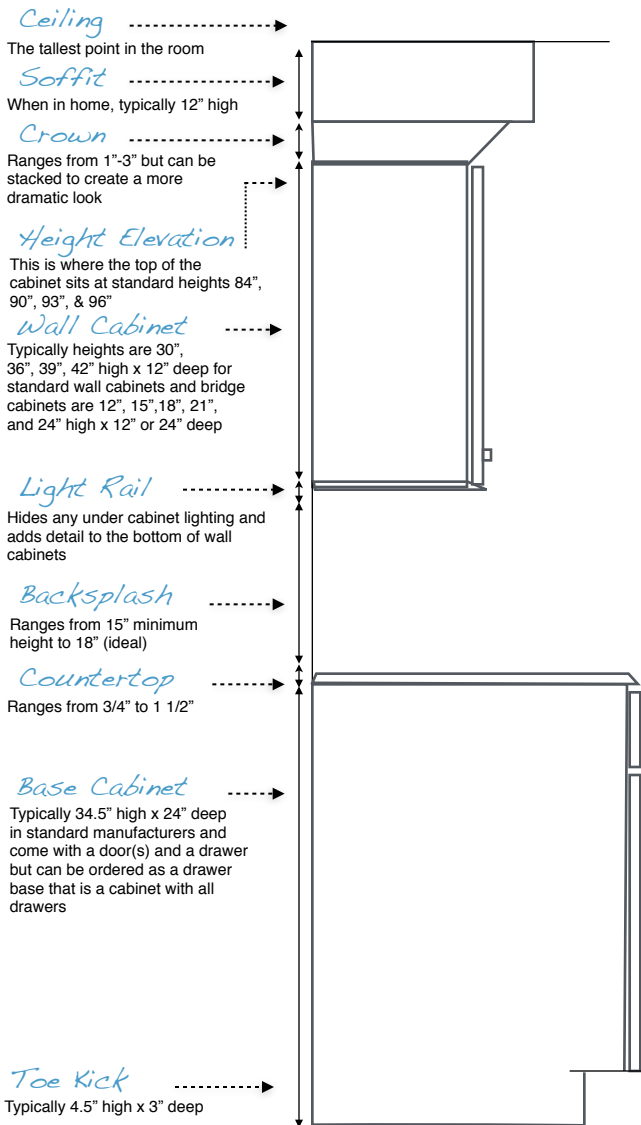



Find A Corner

Start from one corner in the room, measure over all length, and then continue around the room.



Inches

We do our designs in inches, if the original is in inches it is easier to check that we are all on the same page.



Cabinets

Let us know where you would like cabinets in your space. We can suggest spaces but we are not in your home nor know the flow to different rooms.



Include Trim

When measuring your room, note location of windows, doors and openings and always include the trim in your measurements. If you are replacing trim please make sure you accommodate for that.



Overhead View

Always draw the whole kitchen from an overhead view. Foot traffic pattern and proper spacial planning is more easily visualized from an overhead view and what our designers use. Elevations of each wall can be provided by our designers when you order.



Appliance Locations

Note where you would like appliances and be sure to note the location of any gas line, water line, or electrical that must stay in a specific spot.



Appliance Specs

It is very important to let us know the exact appliances you are using. If they have not been chosen yet, then we can use standard sizes but would need to confirm upon ordering that you then purchase the correct sizes.



Photos

This helps us imagine the space better and also the possibility of us catching something that wasn't discussed. Even if there is an existing kitchen or no kitchen, it helps.



Reconfiguring

If anything in the space is going to change, please note what you hope to do. It is suggested that you speak with a contractor or architect prior to ordering to confirm your planned changes are possible. This includes plumbing, tile, flooring, water, windows, doors, & walls.



Door Swings

We want to make sure your cabinets aren't in the way of a door or the doors opening completely or that entry doors do not hit your new cabinetry.

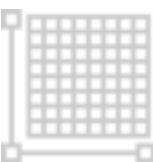

Scale

Please try to draw as close to scale as possible. Typically on the grid you can use each block as one foot, 6 inches or 3 inches depending on your space. This helps ensure everything is aligning correctly.



Client

Room Attributes

Ceiling Height:

Soffit Height:

Ceiling Height:

Soffit Height:

Special Notes

Window Measurements

	<i>Width</i>	<i>Height</i>	<i>Distance to floor</i>
<i>A</i>			
<i>B</i>			
<i>C</i>			
<i>D</i>			

A
B
C
D

1 Block = in

Client Info

Name: _____

Email: _____

Phone: _____

In order to do a complete design and accurate quote we will need to know the exact sizes of all of the appliances that are going to be used in the new kitchen. If you have any Manufacturer Spec Sheets, please include them in your email or fax along with your kitchen plan. NOTE: Most Appliance Manufacturers will require modifying a cabinet which could include cutting or adding pieces for your choosing to achieve a built in look.



Appliances

IN YOUR KITCHEN DESIGN

Range

Brand/Model	Width	Depth	Height
* _____	_____	_____	_____

*30" Free Standing

Cook-top

Brand/Model	Width	Depth	Height
_____	_____	_____	_____

Oven

Brand/Model	Width	Depth	Height
_____	_____	_____	_____

Hood

Brand/Model	Width	Depth	Height
_____	_____	_____	_____

Microwave

Brand/Model	Width	Depth	Height
* _____	_____	_____	_____

*30" Over Range

Refrigerator

Brand/Model	Width	Depth	Height
* _____	_____	_____	_____

*36" Free Standing

Dishwasher

Brand/Model	Width	Depth	Height
* _____	_____	_____	_____

*24" Slide In

Other ex: wine fridge, warming drawer, additional oven...

Brand/Model	Width	Depth	Height
_____	_____	_____	_____
_____	_____	_____	_____
_____	_____	_____	_____

*Appliances have typical sizes and if left blank will be used